

ECO Analyzer/Charger

®

MADE IN
USA BY:
W & W Manufacturing Co.



Charge Battery



Analyze battery

ECO Analyzer/Charger

One unit will:

- a) Analyze your battery
- b) Charge your Battery
- c) Li-ion - NiCd - NiMh

Table of contents

<u>Page</u>	<u>Description</u>
1	Operation of ECO Analyzer - Charger
2	Analyzer and Charger Displays
3 READ FIRST	Cup installation and removal
3	Specifications

<u>Operations</u>		
	Analyzer	Charger
Display (1) No Battery installed	No battery Installed, press Function button to select Analyzer or Charger Mode.	No battery Installed,
Display (2) Battery installed	Battery installed, press function button to select Batt chemistry, NiCd or Lithium	Battery installed, the dots in the lower left corner will go back and fourth indicating the battery is Charging
Display (3) Battery installed	Battery installed, The dots in the lower left corner will go back and fourth indicating the battery is Charging	Flashing display indicates battery is Charged
Display (4) Battery installed	Battery installed, the dots in the lower Right corner will go back and Forth indicating the Batt is discharging and giving the Cap. As the Batt discharges in mAh	
Display (5) Battery installed	Battery installed, the dots in the lower Left corner will go back and Forth indicating the Batt is recharging and giving the Cap. As the Batt. recharges in mAh	
Display (6) Battery installed	Battery Analyzed actual Capacity of battery in mAh	

Eco Analyzer/Charger

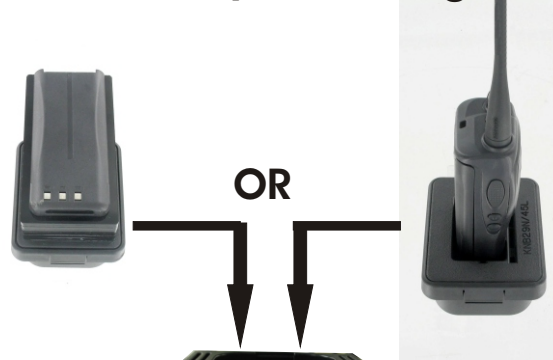

Function Button
only used in
Analyzer Mode

Analyzer

Charger

Analyzer ready	Display 1	Charger ready
Select Chemistry NiCd	Display 2	Charging
Analyzer Chg.	Display 3	Battery Charged Display Flashing
Analyzer Dischg. 1530mAh	Display 4	
Analyzer Rechg. 2000mAh	Display 5	
Batt. Capacity 2000 mAh Display Flashing	Display 6	

Specification

- A) **Charge:** Li-ion/polymer battery packs, max. two cells/pack.
- B) **Charge/:** NiCd and NiMh battery packs, max. ten cells/pack
- C) **Charge current:** Battery dependent, max. 1,100 mAh
- D) **Analyzes only** : 1 cell Li-ion/polymer battery pack, disch at 150mAh.
Two cell Li-ion/polymer and six cell Nickle based battery disch. @ 300mAh
Ten cell Nickel based battery discharge @ 450mAh

*



Optional Load for
7.2V nickel based battery or 7.4V battery Li-ion
Discharges at 500 mA.

*



Optional Load for
3.7V Li-ion battery
discharges at 500 mA.

ECO Analyzer /Charger Cup Installation and Removal

Unit without cup.



1. Line up contacts of cup with Charger contacts.

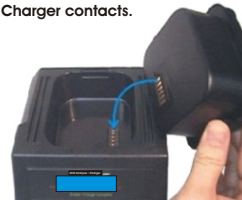

2. Push cup down until tabs lock in place.



3. IMPORTANT:
BE SURE CUP IS INSTALLED
PRIOR TO
Applying power to unit.



4. **Important!** Disconnect power prior to removing cup.

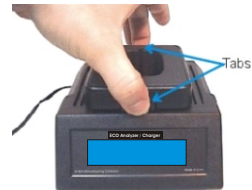

To remove cup, push locking tabs in from both sides.

6. Lift cup straight up.



W & W Manufacturing Co.

800 South Broadway, Hicksville, NY 11801

U.S. & Canada: 800-221-0732 / 516-942-0011 fax: 516-942-1944

www.ww-manufacturing.com